

# Ringlok® double ferrule OD compression fittings

## Blanking end metric

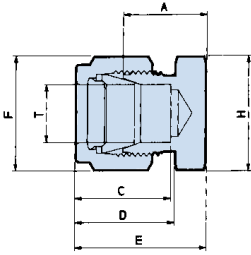

T tube OD	part number	A	C	D	E	F hex	H hex
3"	BE-M3-SS	13.4"	13.4"	15.7"	20.4"	7/16"	7/16"
4"	BE-M4-SS	14.3"	14.2"	16.5"	21.3"	1/2"	7/16"
6"	BE-M6-SS	15.9"	16"	18.2"	23.8"	9/16"	9/16"
8"	BE-M8-SS	17.5"	16.7"	19"	25.4"	11/16"	9/16"
10"	BE-M10-SS	18.2"	17.5"	19.8"	26.1"	3/4"	11/16"
12"	BE-M12-SS	18.7"	23.1"	22.3"	29.1"	7/8"	7/8"
16"	BE-M16-SS	22"	24.6"	22.3"	32.4"	1"	15/16"
20"	BE-M20-SS	23.2"	24.6"	22.3"	33.6"	1 5/16"	1 1/8"
25"	BE-M25-SS	29.7"	31.2"	26.6"	42.1"	1 1/2"	1 1/2"

## Compression nut

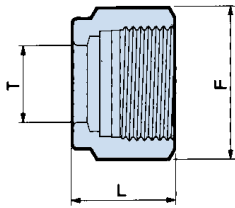

T tube OD	part number	L	F hex	T tube OD	part number	L	F hex
1/16"	CN-01-SS	0.31"	5/16"	3mm	CN-M3-SS	12mm	7/16"
1/8"	CN-1-SS	0.47"	7/16"	4mm	CN-M4-SS	12mm	1/2"
3/16"	CN-03-SS	0.47"	1/2"	6mm	CN-M6-SS	12.7mm	9/16"
1/4"	CN-2-SS	0.5"	9/16"	8mm	CN-M8-SS	13.4mm	11/16"
3/8"	CN-3-SS	0.56"	11/16"	10mm	CN-M10-SS	14.2mm	3/4"
1/2"	CN-4-SS	0.69"	7/8"	12mm	CN-M12-SS	17.5mm	7/8"
5/8"	CN-5-SS	0.69"	1"	16mm	CN-M16-SS	17.5mm	1"
3/4"	CN-6-SS	0.69"	1 1/8"	20mm	CN-M20-SS	17.5mm	1 5/16"
1"	CN-8-SS	0.81"	1 1/2"	25mm	CN-M25-SS	20.5mm	1 1/2"

## Front sealing

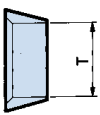

T tube OD	part number	T tube OD	part number
1/16"	FR-01-SS	3"	FR-M3-SS
1/8"	FR-1-SS	4"	FR-M4-SS
3/16"	FR-03-SS	6"	FR-M6-SS
1/4"	FR-2-SS	8"	FR-M8-SS
3/8"	FR-3-SS	10"	FR-M10-SS
1/2"	FR-4-SS	12"	FR-M12-SS
5/8"	FR-5-SS	16"	FR-M16-SS
3/4"	FR-6-SS	20"	FR-M20-SS
1"	FR-8-SS	25"	FR-M25-SS

## Back sealing

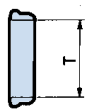

T tube OD	part number	T Tube OD	part number
1/16"	BR-01-SS	3"	BR-M3-SS
1/8"	BR-1-SS	4"	BR-M4-SS
3/16"	BR-03-SS	6"	BR-M6-SS
1/4"	BR-2-SS	8"	BR-M8-SS
3/8"	BR-3-SS	10"	BR-M10-SS
1/2"	BR-4-SS	12"	BR-M12-SS
5/8"	BR-5-SS	16"	BR-M16-SS
3/4"	BR-6-SS	20"	BR-M20-SS
1"	BR-8-SS	25"	BR-M25-SS