

RINGLOK TWIN FERRULE OD COMPRESSION FITTINGS

Straight coupling

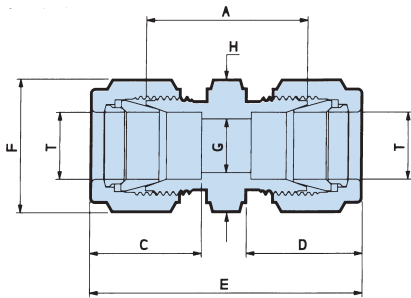

T tube OD	part numberA	C	D	E	F	H hex	G hex	min
1/16"	SC-01-SS	0.81"	0.35"	0.47"	1.13"	5/16"	5/16"	0.05"
1/8"	SC-1-SS	0.88"	0.52"	0.62"	1.43"	7/16"	7/16"	0.09"
3/16"	SC-03-SS	0.94"	0.55"	0.65"	1.49"	1/2"	1/2"	0.13"
1/4"	SC-2-SS	1.03"	0.63"	0.72"	1.66"	9/16"	9/16"	0.19"
3/8"	SC-3-SS	1.19"	0.69"	0.78"	1.81"	11/16"	11/16"	0.28"
1/2"	SC-4-SS	1.22"	0.91"	0.88"	2.04"	7/8"	7/8"	0.41"
5/8"	SC-5-SS	1.25"	0.97"	0.88"	2.07"	1"	15/16"	0.50"
3/4"	SC-6-SS	1.31"	0.97"	0.88"	2.13"	11/8"	11/8"	0.63"
1"	SC-8-SS	1.59"	1.23"	1.05"	2.57"	11/2"	11/2"	0.88"

Straight coupling metric

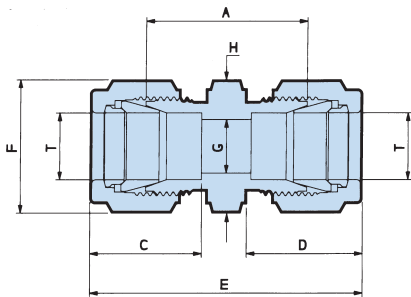

T tube OD	part numberA	C	D	E	F	H hex	G hex	min
3mm	SC-M3-SS	22.3mm	13.4mm	15.7mm	36.3mm	7/16"	7/16"	2.3mm
4mm	SC-M4-SS	23.8mm	14.2mm	16.5mm	37.8mm	1/2"	7/16"	2.7mm
6mm	SC-M6-SS	26.1mm	16mm	18.2mm	41.9mm	9/16"	9/16"	4.8mm
8mm	SC-M8-SS	27.6mm	16.7mm	19mm	43.4mm	11/16"	9/16"	6.3mm
10mm	SC-M10-SS	30.2mm	17.5mm	19.8mm	46mm	3/4"	11/16"	7.8mm
12mm	SC-M12-SS	31mm	23.1mm	22.3mm	51.8mm	7/8"	7/8"	9.6mm
16mm	SC-M16-SS	31.7mm	24.6mm	22.3mm	52.5mm	1"	15/16"	12.7mm
20mm	SC-M20-SS	33.2mm	24.6mm	22.3mm	54mm	15/16"	11/8"	16.7mm
25mm	SC-M25-SS	40.3mm	31.2mm	26.6mm	65.1mm	11/2"	11/2"	22.3mm

Bulkhead coupling

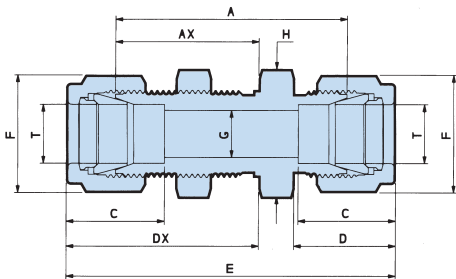

T tube OD	part numberA	Ax	C	D	Dx	E	F	H hex	G hex	panel min	panel hole drill size	thick- ness max
1/16"	BC-01-SS	0.97"	0.53"	0.35"	0.47"	0.69"	1.29"	5/16"	5/16"	0.05"	13/64"	0.13"
1/8"	BC-1-SS	1.5"	0.97"	0.52"	0.62"	1.24"	2.06"	7/16"	1/2"	0.09"	21/64"	0.44"
3/16"	BC-03-SS	1.59"	1"	0.55"	0.65"	1.27"	2.15"	1/2"	9/16"	0.13"	25/64"	0.5"
1/4"	BC-2-SS	1.69"	1.03"	0.63"	0.72"	1.34"	2.31"	9/16"	11/16"	0.19"	29/64"	0.5"
3/8"	BC-3-SS	1.88"	1.16"	0.69"	0.78"	1.47"	2.5"	11/16"	3/4"	0.28"	37/64"	0.5"
1/2"	BC-4-SS	2.03"	1.25"	0.91"	0.88"	1.66"	2.85"	7/8"	15/16"	0.41"	49/64"	0.56"
5/8"	BC-5-SS	2.13"	1.28"	0.97"	0.88"	1.69"	2.95"	1"	1 1/8"	0.5"	57/64"	0.56"
3/4"	BC-6-SS	2.31"	1.47"	0.97"	0.88"	1.88"	3.13"	1 1/8"	1 5/16"	0.63"	1 1/64"	0.69"
1"	BC-8-SS	2.81"	1.78"	1.23"	1.05"	2.27"	3.79"	1 1/2"	1 1/2"	0.88"	1 21/64"	0.88"

Bulkhead coupling metric

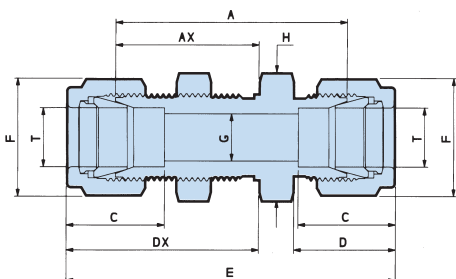

T tube OD	part numberA	Ax	C	D	Dx	E	F	H hex	G hex	panel min	panel hole drill size	thick- ness max
3mm	BC-M3-SS	38.8mm	24.6mm	13.4mm	15.7mm	31.6mm	52.8mm	7/16"	9/16"	2.3mm	8.3mm	11.1mm
4mm	BC-M4-SS	40.5mm	25.4mm	14.2mm	16.5mm	32.4mm	54.5mm	1/2"	9/16"	2.7mm	9.9mm	12.7mm
6mm	BC-M6-SS	42.8mm	26.1mm	16mm	18.2mm	34mm	58.6mm	9/16"	11/16"	4.8mm	11.5mm	12.7mm
8mm	BC-M8-SS	46.1mm	28.7mm	16.7mm	19mm	36.6mm	61.9mm	11/16"	3/4"	6.3mm	13.1mm	14.2mm
10mm	BC-M10-SS	48.4mm	29.4mm	17.5mm	19.8mm	37.3mm	64.2mm	3/4"	7/8"	7.8mm	16.3mm	12.7mm
12mm	BC-M12-SS	51.5mm	31.7mm	23.1mm	22.3mm	42.1mm	72.3mm	7/8"	1 5/16"	9.6mm	19.4mm	14.2mm
16mm	BC-M16-SS	53.9mm	32.5mm	24.6mm	22.3mm	42.9mm	74.7mm	1"	1 1/8"	12.7mm	22.6mm	14.2mm
20mm	BC-M20-SS	58.7mm	37.3mm	24.6mm	22.3mm	47.7mm	79.5mm	1 5/16"	1 5/16"	16.7mm	27.4mm	17.5mm
25mm	BC-M25-SS	71.3mm	45.2mm	31.2mm	26.6mm	57.5mm	96.1mm	1 1/2"	1 1/2"	22.3mm	33.7mm	22.3mm