

BSP – BSPP male union 3000lb class

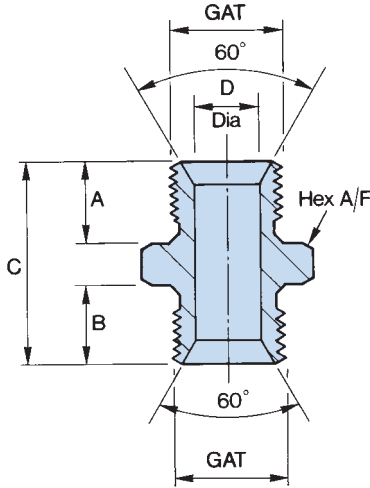

thread size GAT	part number	A	B	C	D dia	hex A/F
1/8" BSP 1/8" BSP	U1	0.450"	0.450"	1.150"	0.125"	0.562"
1/4" BSP 1/8" BSP	U2R	0.450"	0.450"	1.150"	0.125"	0.750"
1/4" BSP 1/4" BSP	U2	0.450"	0.450"	1.150"	0.250"	0.750"
3/8" BSP 1/8" BSP	U3R/1	0.530"	0.450"	1.230"	0.125"	0.875"
3/8" BSP 1/4" BSP	U3R	0.530"	0.450"	1.230"	0.250"	0.875"
3/8" BSP 3/8" BSP	U3	0.530"	0.530"	1.312"	0.375"	0.875"
1/2" BSP 1/4" BSP	U4R/2	0.600"	0.450"	1.362"	0.250"	1.125"
1/2" BSP 3/8" BSP	U4R	0.600"	0.530"	1.442"	0.375"	1.125"
1/2" BSP 1/2" BSP	U4	0.600"	0.600"	1.512"	0.500"	1.125"
5/8" BSP 5/8" BSP	U5	0.625"	0.625"	1.562"	0.531"	1.125"
3/4" BSP 3/8" BSP	U6R/3	0.750"	0.530"	1.655"	0.375"	1.300"
3/4" BSP 1/2" BSP	U6R	0.750"	0.600"	1.725"	0.500"	1.300"
3/4" BSP 5/8" BSP	U6R/5	0.750"	0.625"	1.750"	0.531"	1.300"
3/4" BSP 3/4" BSP	U6	0.750"	0.750"	1.875"	0.687"	1.300"
1" BSP 3/8" BSP	U8R/3	0.800"	0.530"	1.705"	0.375"	1.670"
1" BSP 1/2" BSP	U8R/4	0.800"	0.600"	1.775"	0.500"	1.670"
1" BSP 3/4" BSP	U8R	0.800"	0.750"	1.925"	0.687"	1.670"
1" BSP 1" BSP	U8	0.800"	0.800"	1.975"	0.875"	1.670"
1 1/4" BSP 1" BSP	U10R	0.800"	0.800"	2.037"	0.875"	2.050"
1 1/4" BSP 1 1/4" BSP	U10	0.800"	0.800"	2.037"	1.125"	2.050"
1 1/2" BSP 3/4" BSP	U12R/6	0.900"	0.750"	2.087"	0.687"	2.220"
1 1/2" BSP 1" BSP	U12R/8	0.900"	0.800"	2.137"	0.875"	2.220"
1 1/2" BSP 1 1/4" BSP	U12R	0.900"	0.800"	2.137"	1.125"	2.220"
1 1/2" BSP 1 1/2" BSP	U12	0.900"	0.900"	2.237"	1.375"	2.220"
2" BSP 1" BSP	U16R/8	1.000"	0.800"	2.237"	0.875"	2.750"
2" BSP 1 1/4" BSP	U16R/10	1.000"	0.800"	2.237"	1.125"	2.750"
2" BSP 1 1/2" BSP	U16R	1.000"	0.900"	2.337"	1.375"	2.750"
2" BSP 2" BSP	U16	1.000"	1.000"	2.437"	1.750"	2.750"

BSPP – bulkhead union 3000lb class with hexagon back nut

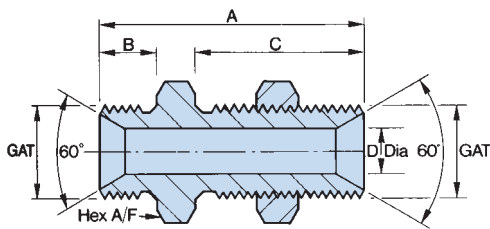

thread size GAT	part number	A	B	C	D dia	hex A/F	bulkhead bore dia
1/4"	BU2	2.125"	0.450"	1.400"	0.250"	0.750"	0.520"
3/8"	BU3	2.192"	0.550"	1.410"	0.375"	0.875"	0.656"
1/2"	BU4	2.350"	0.600"	1.500"	0.510"	1.125"	0.828"
3/4"	BU6	2.875"	0.750"	1.750"	0.760"	1.300"	1.032"
1"	BU8	2.975"	0.800"	1.800"	0.875"	1.670"	1.312"
1 1/2"	BU12	3.310"	0.900"	1.900"	1.310"	2.220"	1.990"

BSPP – union nut 3000lb class

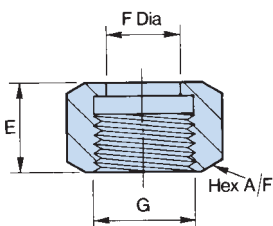

thread size G	part number	E	F dia	hex A/F
1/8" BSP	UN1	0.500"	0.250"	0.562"
1/4" BSP	UN2	0.500"	0.365"	0.750"
3/8" BSP	UN3	0.593"	0.490"	0.875"
1/2" BSP	UN4	0.750"	0.610"	1.125"
3/4" BSP	UN6	0.750"	0.870"	1.300"
1" BSP	UN8	0.937"	1.100"	1.670"
1 1/4" BSP	UN10	1.000"	1.390"	2.050"
1 1/2" BSP	UN12	1.125"	1.650"	2.220"
2" BSP	UN16	1.375"	2.125"	2.750"