

## DUOLOC SINGLE FERRULE OD COMPRESSION FITTINGS

### BSP parallel female stud coupling

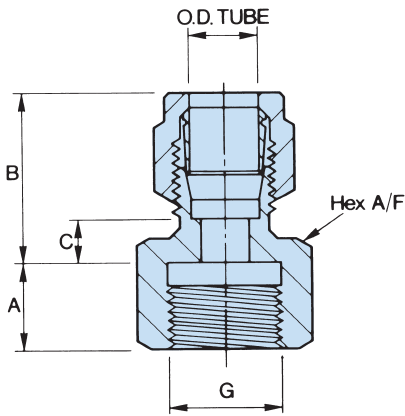

OD tube	thread size G	part number	A	B	C	hex A/F
6mm	1/8" BSP	6m/1P FSC	12.0mm	24.0mm	9.0mm	14.0mm
6mm	1/4" BSP	6m/2P FSC	12.0mm	24.0mm	9.0mm	19.0mm
6mm	3/8" BSP	6m/3P FSC	13.0mm	24.0mm	9.0mm	22.0mm
6mm	1/2" BSP	6m/4P FSC	16.0mm	24.0mm	9.0mm	27.0mm
8mm	1/4" BSP	8m/2P FSC	12.0mm	27.0mm	9.0mm	19.0mm
8mm	1/2" BSP	8m/4P FSC	16.0mm	27.0mm	9.0mm	27.0mm
10mm	1/4" BSP	10m/2P FSC	12.0mm	27.0mm	9.0mm	19.0mm
10mm	3/8" BSP	10m/3P FSC	14.0mm	27.0mm	9.0mm	22.0mm
10mm	1/2" BSP	10m/4P FSC	16.0mm	27.0mm	9.0mm	27.0mm
12mm	1/4" BSP	12m/2P FSC	12.0mm	27.0mm	9.0mm	19.0mm
12mm	3/8" BSP	12m/3P FSC	14.0mm	27.0mm	9.0mm	22.0mm
12mm	1/2" BSP	12m/4P FSC	16.0mm	27.0mm	9.0mm	27.0mm
15mm	1/2" BSP	15m/4P FSC	16.0mm	29.0mm	10.0mm	27.0mm
16mm	1/2" BSP	16m/4P FSC	16.0mm	31.0mm	10.0mm	28.5mm
18mm	3/4" BSP	18m/6P FSC	19.0mm	31.5mm	10.0mm	33.0mm
20mm	3/4" BSP	20m/6P FSC	19.0mm	32.0mm	11.0mm	33.0mm
22mm	1/2" BSP	22m/4P FSC	16.0mm	36.0mm	11.0mm	33.0mm
22mm	3/4" BSP	22m/6P FSC	19.0mm	36.0mm	11.0mm	33.0mm
25mm	3/4" BSP	25m/6P FSC	19.0mm	36.0mm	11.0mm	38.0mm

### BSP parallel gauge washer PTFE

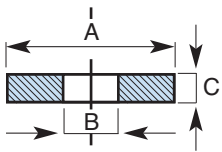

thread size G	part number	A	B	C
1/8"	GW1	8.6mm	4.0mm	2.6mm
1/4"	GW2	11.5mm	4.1mm	2.6mm
3/8"	GW3	14.8mm	6.0mm	2.6mm
1/2"	GW4	18.5mm	6.0mm	3.2mm
3/4"	GW6	24.0mm	12.7mm	3.2mm
1"	GW8	30.4mm	17.0mm	3.2mm