

## RINGLOK TWIN FERRULE OD COMPRESSION FITTINGS

### BSP parallel male standpipe adaptor

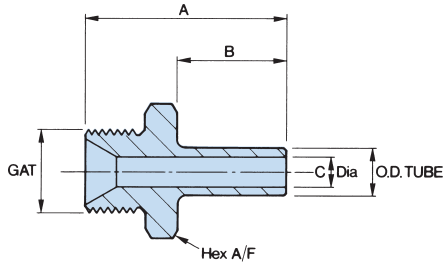

OD	thread size GAT	part number	A	B	C	hex A/F
1/4"	1/8" BSP	<b>2/1P MSA</b>	1.793"	1.093"	0.100"	0.562"
1/4"	1/4" BSP	<b>2/2P MSA</b>	1.793"	1.093"	0.100"	0.750"
1/4"	3/8" BSP	<b>2/3P MSA</b>	1.873"	1.093"	0.100"	0.875"
1/4"	1/2" BSP	<b>2/4P MSA</b>	2.000"	1.093"	0.100"	1.125"
3/8"	1/4" BSP	<b>3/2P MSA</b>	1.793"	1.093"	0.157"	0.750"
3/8"	3/8" BSP	<b>3/3P MSA</b>	1.873"	1.093"	0.157"	0.875"
3/8"	1/2" BSP	<b>3/4P MSA</b>	2.000"	1.093"	0.157"	1.125"
1/2"	1/4" BSP	<b>4/2P MSA</b>	1.793"	1.093"	0.312"	0.750"
1/2"	3/8" BSP	<b>4/3P MSA</b>	1.873"	1.093"	0.312"	0.875"
1/2"	1/2" BSP	<b>4/4P MSA</b>	2.000"	1.093"	0.312"	1.125"
3/4"	1/2" BSP	<b>6/4P MSA</b>	2.162"	1.250"	0.437"	1.125"
3/4"	3/4" BSP	<b>6/6P MSA</b>	2.375"	1.250"	0.437"	1.300"
1"	3/4" BSP	<b>8/6P MSA</b>	2.625"	1.500"	0.437"	1.300"
1"	1" BSP	<b>8/8P MSA</b>	2.675"	1.500"	0.750"	1.670"
6mm	1/4" BSP	<b>6M/2P MSA</b>	45.5mm	28mm	2.5mm	19mm
10mm	1/4" BSP	<b>10M/2P MSA</b>	45.5mm	28mm	6mm	19mm
10mm	3/8" BSP	<b>10M/3P MSA</b>	47.5mm	28mm	6mm	22mm
10mm	1/2" BSP	<b>10M/4P MSA</b>	50mm	28mm	6mm	28.5mm
12mm	1/4" BSP	<b>12M/2P MSA</b>	45.5mm	28mm	8mm	19mm
12mm	3/8" BSP	<b>12M/3P MSA</b>	47.5mm	28mm	8mm	22mm
12mm	1/2" BSP	<b>12M/4P MSA</b>	50mm	28mm	8mm	28.5mm
15mm	3/8" BSP	<b>15M/3P MSA</b>	50mm	30mm	9.5mm	22mm
15mm	1/2" BSP	<b>15M/4P MSA</b>	53mm	30mm	10mm	28.5mm
16mm	1/2" BSP	<b>16M/4P MSA</b>	53mm	30mm	10mm	28.5mm
18mm	1/2" BSP	<b>18M/4P MSA</b>	53mm	30mm	10mm	28.5mm
20mm	3/4" BSP	<b>20M/6P MSA</b>	59mm	30mm	10mm	33.0mm
22mm	3/4" BSP	<b>22M/6P MSA</b>	62mm	33.5mm	16mm	33.0mm
25mm	3/4" BSP	<b>25M/6P MSA</b>	62mm	33.5mm	16mm	33.0mm